



NEW BREMEN
LOCAL SCHOOLS

Proposed OSFC School Facilities Project



TONIGHT'S AGENDA:

- ◆ Why Now?
- ◆ Preliminary Building and Site Plans
- ◆ Financial Plan
- ◆ Existing Buildings and Property



NEW BREMEN
LOCAL SCHOOLS

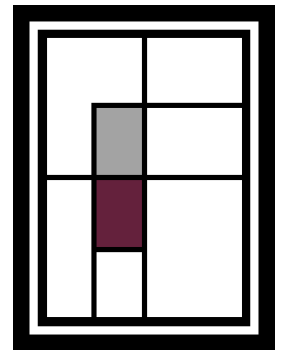

◆ Why Now?

- ❖ The Ohio School Facilities Commission is offering to co-fund \$6.8 million
- ❖ Interest rates are very low right now, which will lower the overall cost to taxpayers for the project
- ❖ Continual repairs to the current building are ongoing and will only get costlier
- ❖ The longer we wait to build, the higher the costs of building will become



NEW BREMEN
LOCAL SCHOOLS

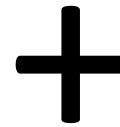

Preliminary Building Project Plan

- Scope of the New Building
- Site Safety / Transportation Plan
- Potential Floor Diagram
- Construction Timeline

What is included in the new building?

- ❖ OSFC Program of Requirements for K-6 Building
- ❖ Locally Funded Initiatives
 - ❖ Additional Square Footage (For Grades 7-8)
 - ❖ Future Connector
 - ❖ Potential Material Upgrades
 - ❖ Technology

Site Study

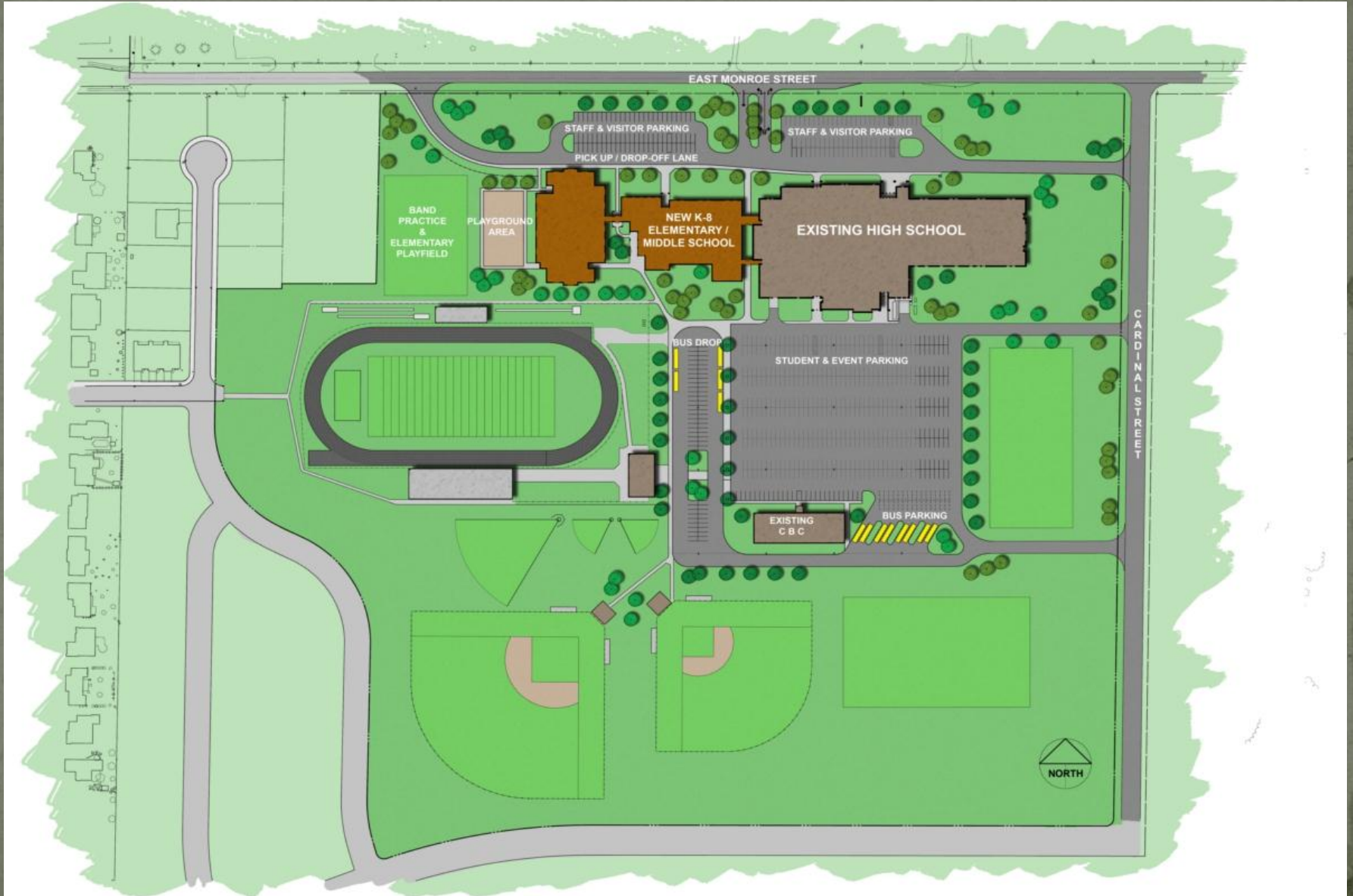

Potential Floor Diagram

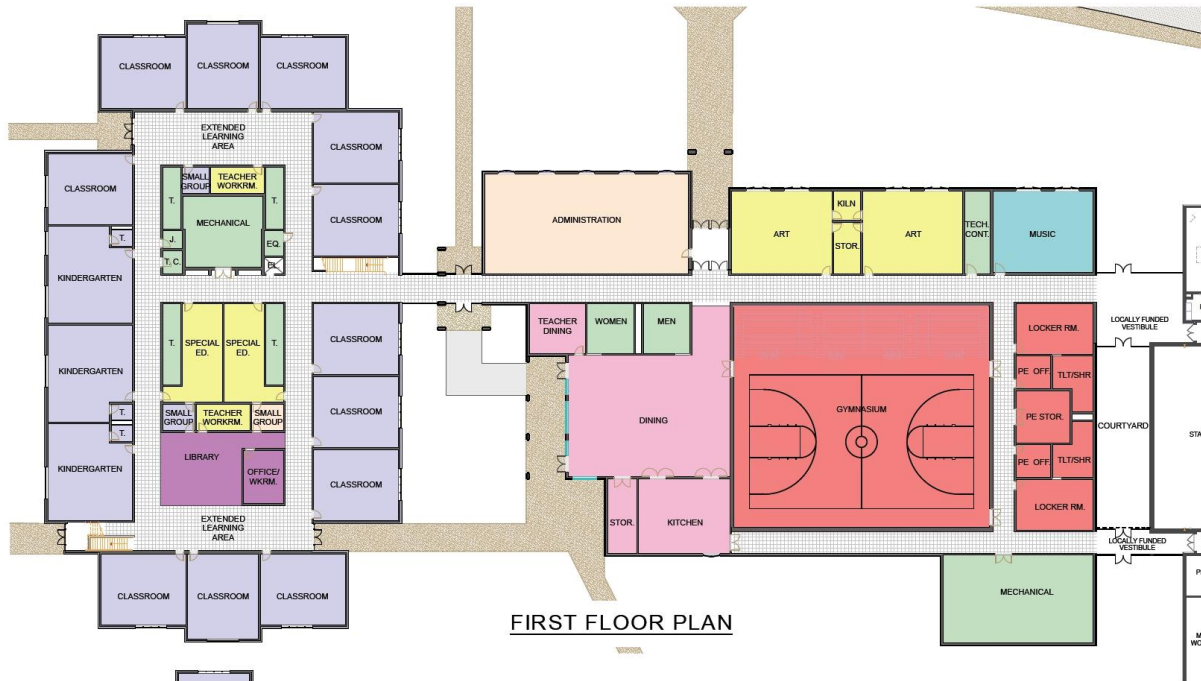

FIRST FLOOR PLAN

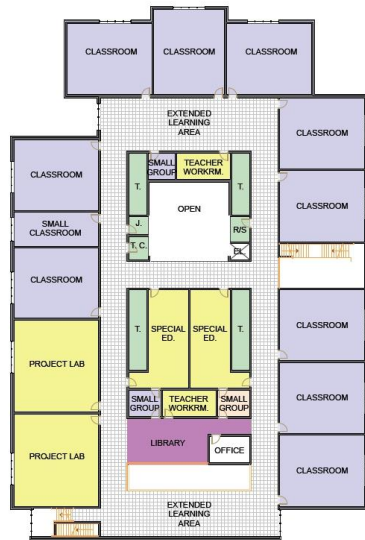

SECOND FLOOR PLAN

ROOM LEGEND

- PHYSICAL EDUCATION
- MUSIC
- CLASSROOMS
- SPECIALIZED / TECHNICAL CLASSROOMS
- BUILDING SERVICES
- SCHOOL OFFICES/ GUIDANCE
- DINING / FOOD SERVICES
- MEDIA CENTER



Tentative Construction Timeline

- Design Phase
 - ◆ Primary Election 2012 – Early Spring 2013
- Bid Phase
 - ◆ Early Spring 2013
- Construction Phase
 - ◆ Spring 2013 – Summer 2014
- Project Completion
 - ◆ August 2014

◆ Financial Plan

- ❖ State Share / Local Share
- ❖ Locally Funded Initiatives (LFI)
- ❖ Millage Rates and Costs



NEW BREMEN
LOCAL SCHOOLS

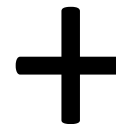



NEW BREMEN LOCAL SCHOOLS



K-8 BUILDING WITH UPGRADES * COMPARED TO ALL LOCAL RENOVATION

	Total Cost	State Share	Local Share
New K-8 Building	\$19,845,203	\$6,845,203	\$13,000,000
K-8 Renovation Locally (No OSFC)	\$12,470,027	\$0	\$12,470,027

* Upgrades similar to standard set by the community for the current High School building

LOCAL COSTS OSFC PROJECT APPROXIMATE DOLLARS & MILLAGE

PROJECT	TOTAL COST	STATE SHARE	LOCAL SHARE
New K-8 Building	\$19,845,203	\$6,845,203	\$13,000,000

PORTION OF PROJECT	MILLAGE
Bond Issue for Construction of New K-8 Building	7.30
Required OSFC Maintenance Levy	0.50

MILLAGE SUMMARY

BALLOT / ADJUSTMENTS / IMPACT

PORTION OF BALLOT LANGUAGE	MILLAGE
33 Year Bond Issue for Construction of New K-8 Building	7.30
Continuous Permanent Improvement (Covers 0.50 Mill OSFC Maintenance Levy + 0.50 Local Choice)	1.00
TOTAL BALLOT MILLAGE	8.30

ADJUSTMENTS	MILLAGE
Cease Collection of Current PI Levy	-0.75
TOTAL ADJUSTMENTS	-0.75

IMPACT	MILLAGE
TOTAL BALLOT MILLAGE	8.30
TOTAL ADJUSTMENTS	-0.75
TOTAL MILLAGE IMPACT OF PROPOSED PLAN	7.55



NEW BREMEN LOCAL SCHOOLS

MILLAGE RATE PERSPECTIVE

PROJECT	YEAR	GRADE RANGE	NUMBER OF GRADES SERVED	MILLAGE RATE
High School	1996	9 - 12	4	8.86
Elementary	2012	K - 8	9	7.55

EXAMPLE COSTS TO HOME OWNER BASED ON IMPACT MILLAGE

County Auditor Appraised Value	\$100,000
Annual Costs	\$231.22
Monthly Costs	\$19.27
Weekly Costs	\$4.45
Daily Costs	\$0.63

◆ What will be done with the existing facilities?

- ❖ Elementary and Junior High Buildings
- ❖ Baseball Diamond & Football Field
- ❖ Track and Playground Equipment
- ❖ Bus Parking Lot
- ❖ Gymnasium



NEW BREMEN
LOCAL SCHOOLS

◆ Elementary and Junior High Buildings

- ❖ Attempt to sell as is
- ❖ If unable to sell –
 - Demolish
 - Sell the land



NEW BREMEN
LOCAL SCHOOLS

◆ Baseball Diamond & Football Field

- ❖ The village currently helps maintain diamond during the summer
- ❖ Keep to support community group's use
 - ACME Baseball
 - Pony League Baseball
 - Soccer
 - Flag Football



NEW BREMEN
LOCAL SCHOOLS

◆ Track and Playground Equipment

- ❖ Explore possibility of moving playground equipment to new building
- ❖ Sell Land



NEW BREMEN
LOCAL SCHOOLS

◆ Bus Parking Lot

- ❖ Transfer property back to village per existing agreement



NEW BREMEN
LOCAL SCHOOLS

◆ Gymnasium

- ❖ Significant cost to “button up”
- ❖ Significant cost to maintain
- ❖ Costs associated with keeping & maintaining is outside the scope of the project



NEW BREMEN
LOCAL SCHOOLS

QUESTIONS & FEEDBACK:

- ◆ Please consider volunteering for the levy committee.
- ◆ If you have further question or comment, please call the Central Office at 629-8606



NEW BREMEN
LOCAL SCHOOLS

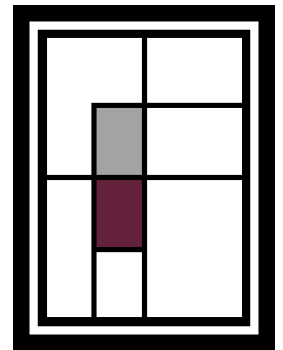



NEW BREMEN
LOCAL SCHOOLS

Proposed OSFC School Facilities Project

